

Focus

Single lever basin mixer 190 without waste set

Surfaces: **Chrome** Article Number: **31518000**



Description

product features

- ComfortZone 190
- projection 159 mm
- normal spray
- flow rate at 3 bar: 5 l/min
- ceramic cartridge
- temperature limitation adjustable
- suitable for continuous flow water heaters
- connection type: G 3/8 connections
- connection dimension: DN15

Technology



Design awards



reddot design award

Product image



Scale drawing

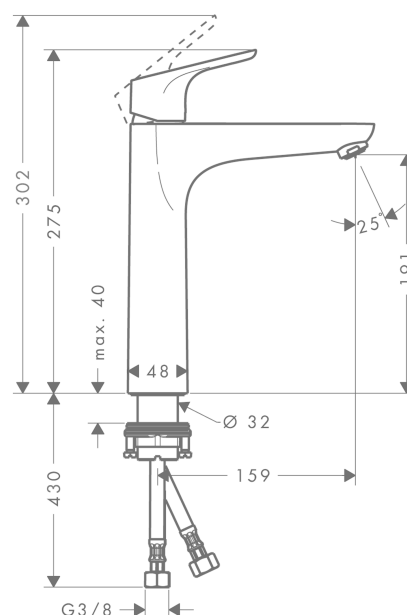

Flowchart

