

## Focus

### Single lever basin mixer 100 without waste set

Surfaces: **Chrome** Article Number: **31517000**



## Description

### product features

- ComfortZone 100
- projection 119 mm
- flow rate at 3 bar: 5 l/min
- ceramic cartridge
- temperature limitation adjustable
- suitable for continuous flow water heaters
- connection type: G 3/8 connections
- connection dimension: DN15

## Technology



## Design awards



reddot design award

## Product image



## Scale drawing

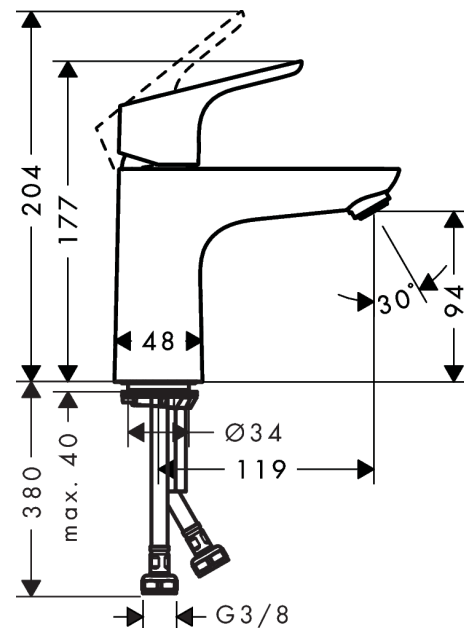

## Flowchart

